

JET COX 45° GLASS PYRAMID

The JET COX 45° Glass Pyramid and Trapezoid Range provides a high quality, aesthetically pleasing, prefabricated glazing solution for a variety of applications.

The slim, elegant, thermally broken aluminium sections are exclusively designed to maximise natural daylight; the choice of glass specification allows thermal and acoustic performance to be given equal consideration and because the units are prefabricated (sizes $\geq 2000\text{mm} \times 2200\text{mm}$ will require site glazing) fitting on site is fast and easy.

TECHNICAL SPECIFICATION

- Fixed or Electrically Operated
- 230V or 24V Electric Actuators
- Fully thermally broken Aluminium System
- Polyester Powder coated RAL 9016 as standard (other RAL colours are available on request)
- 150mm or 300mm PVC-u Upstand
- 'U' Value according to DIN EN ISO 6946
Glass Unit 1.1 W/m²K
- Light Transmission
Thermo-PLUS S3 78%
INFRASTOP Brilliant 66%
- 'G' Value solar heat gain
Thermo-PLUS S3 57%
INFRASTOP Brilliant 36%
- Sound Reduction according to DIN 52210
Opening Lid 33db
Upstand 42-44dB
- Electric Actuators 300mm or 500mm stroke length

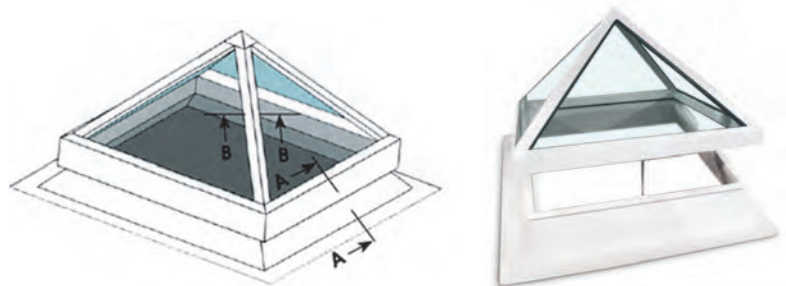

Rooflight Size	Electric Actuators*		Weight (kg) with 300mm Upstand	Upstands - PVC-u	
	230v	24v		150mm	300mm
1000 x 1000	S	S	58	•	•
1200 x 1200	S	S	81	•	•
1500 x 1500	S	S	124	•	•
1800 x 1800	-	D	185	•	•
2000 x 2000	-	D	225	•	•
2200 x 2200	-	D	299	•	•
2500 x 2500	-	D	382	•	•

* S = Single Actuator D= Double Actuator with electrical synchronisation control

Cross section A-A

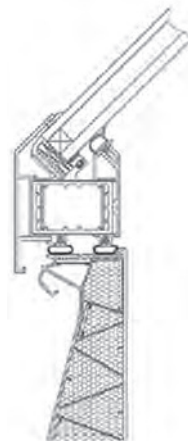

JET COX Glass Pyramid 45° with PVC-u Upstand

Cross section B-B

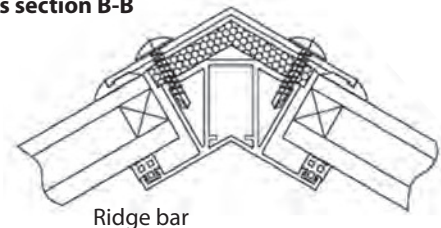

Ridge bar

Cross section C-C

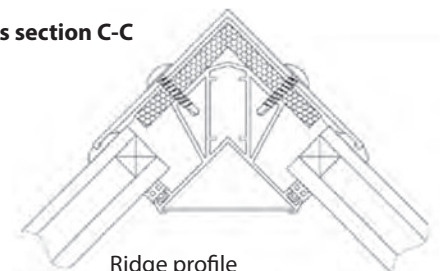

Ridge profile