



## JET COX TUBELIGHT

The JET COX Tubelight was originally designed to transfer light to those small rooms or tight spaces that do not benefit from direct natural daylight. The sole aim of the Tubelight is to maximise daylight whilst minimising heat transfer.

The application of the Tubelight has changed over the years and they now serve many other purposes and offer many other benefits. The low profile design of the Tubelight is aesthetically pleasing and less obtrusive than an out of plane rooflight; ideal where external constructive changes are undesirable or restricted. Internally, the ceiling light (diffuser) is made of coated aluminium (white or brushed alloy) and has a frosted look which is elegant, yet modern.

The Tubelight is also designed to transport light in both a vertical and horizontal direction, and with lengths of up to 8m the Tubelight can be specified to pass through several floors of a building.

The Tubelight is available in two sizes; 250mm and 350mm, and can be specified for pitched roof (15°-60°) or flat roof (>15°) applications.

### Accessories

- **Extension Tube 62.5cm, comes with sleeve**
- **Elbow Tube, 0-45°, comes with sleeve**
- **Inner Dome, Polycarbonate; increased insulation**
- **Installation brackets for extension tubes**
- **Tube Spot**
- **Tube Dimmer**

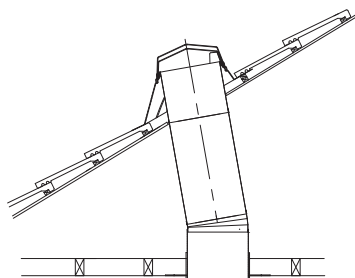
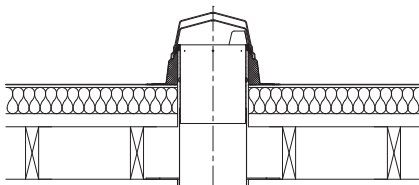

Specification	Model	
	D-250	D-350
<b>PITCHED ROOF (15°-60°)</b>		
ROOF TILE FLASHING	700 X 890	700 X 890
ROOF OPENING DIAMETER	DEPENDS ON THE PITCH OF THE ROOF	
TUBE DIAMETER	250MM	350MM
CEILING LIGHT DIAMETER	320MM	420MM
<b>FLAT ROOF (&lt;15°)</b>		
HEIGHT ABOVE ROOF	280MM	290MM
ROOF OPENING DIAMETER	270MM	370MM
UPSTAND FLANGE DIAMETER	520MM	620MM
LIGHT DISTRIBUTION (APPROX)	12M <sup>2</sup>	20M <sup>2</sup>
<b>U' VALUE</b>		
SINGLE SKIN	3.7 W/M <sup>2</sup> K	3.5 W/M <sup>2</sup> K
DOUBLE SKIN	3.1 W/M <sup>2</sup> K	2.8 W/M <sup>2</sup> K
<b>LIGHT OUTPUT (LUMEN)</b>		
SUMMARY - SUNNY	3,240	5,346
SUMMER - CLOUDY	1,620	2,673
WINTER	648	1,069
<b>MATERIAL SPECIFICATION</b>		
DOMES	PC-POLYCARBONATE	
UPSTAND	DOUBLE SKIN ALUMINIUM INSULATED	
SLOPE ROOF SLATE	HDPE WEATHERING SLATE WITH LEAD FLASHING	
RIGID TUBE	ALUMINIUM WITH SILVER COATING	
FIXATION RING	ABS-PMMA	
DIFFUSER	PMMA	
CEILING LIGHT TRIM	ALUMINIUM	